



Quintas do Campo

Sopra Bolo

QUINTAS DO CAMPO SUBDIVISION - Phase 1

Republic of Cape Verde

Safe Country With Great Weather and Affable People

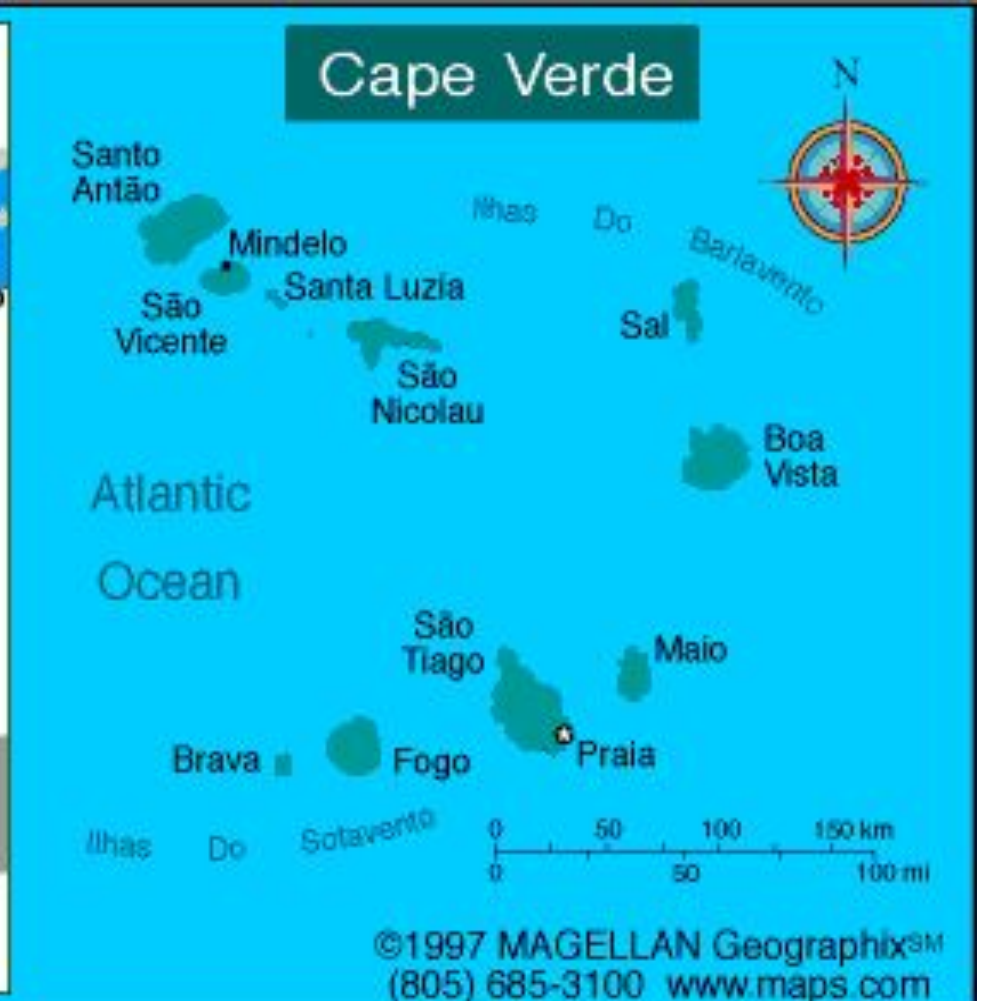
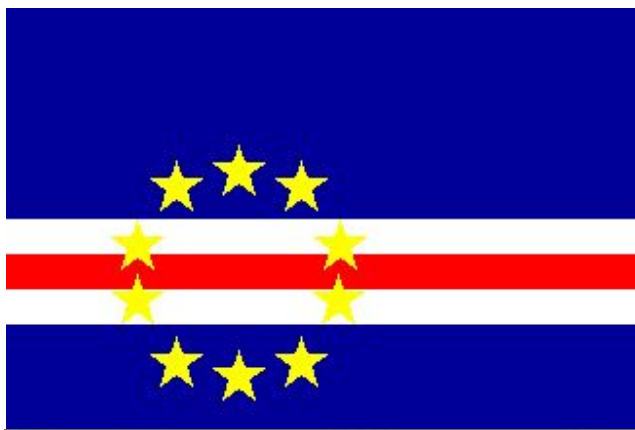

Cape Verde, officially the **Republic of Cape Verde** is an African island state and an archipelago consist of ten volcanic islands. It is located in the Atlantic Ocean, 640 km west of Dakar, Senegal. Other neighbors are Mauritania, Gambia and Guinea-Bissau, all on the western coastline of Africa that runs from Cabo Branco at Bijagós islands. Interestingly, the Cape Verde which names the country does not lie in it but hundreds of miles east, near Dakar, Senegal.

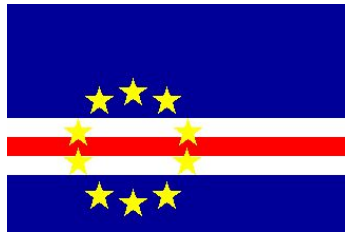

It was discovered in 1460 by Diogo Gomes for the Portuguese crown, who found the uninhabited islands and apparently without evidence of previous human presence. Was a Portuguese colony from the fifteenth century until its independence in 1975.

Santiago Island

Santiago is the largest island of the archipelago of Cape Verde, which belongs to the Sotavento group. Extends for about 75 km long, north to south and about 35 km wide, east-west.

Area: 991 sq km



Ilha de Santiago



The island of Santiago, considered the most African of all and where the contrasts are sharper, offers a multitude of mountains and valleys, paths and trails, in what is the largest island of the archipelago and that accommodates half the country's population.

Live here the history and culture of Cape Verde

Santiago is the island of all contrasts, from the balmy beaches, the unique landscapes, the traces of rurality within, through the fragments of history that transport us to distant times. Meet the birthplace of Capeverdean - Old Town - where reigns, imposing, the Fortaleza Real de São Filipe.

Visit Santiago is to discover the roots of country and marks the settlement, while soaking up the morabeza and the frenetic rhythms of drumming. A visit to the community of "Rabelados" (community that was many years isolated from the rest and that kept ancestral ways of life) imposes itself to the visitor. After a pleasant journey through the island, we came to a bay surrounded by coconut trees, which is one of the most scenic beaches in the archipelago of Cape Verde: Tarrafal. The county, located in the north of the island of Santiago, also home to the former concentration camp of Tarrafal, now transformed into a museum. Created by the Portuguese Government in 1936, the Tarrafal Penal Colony, also known as "Tarrafal Field " was spot during years of atrocities and human rights abuses, until it closed in 1974.



São Domingos

The Municipality of São Domingos is a rural county / municipality of Santiago Island, Cape Verde, with 137.6 square kilometers and 13,305 inhabitants. The Day of the Municipality is March 13. Since 2008, the municipality of São Domingos is governed by the Movement for Democracy.

Area: 137.6 sq km

São Domingos - One Municipality with History

The municipality of São Domingos, the gateway to the interior of Santiago's main tourism winding mountains and green hills of Rui Vaz and Monte Tchota and gorgeous beaches Baixo Beach and Vale da Custa, which is currently one of the most emblematic tourist developments of the country, the **"Sambala Village Investment"**.



The grotto of Ribeirão Cal, the Fossil Dunes of MOIA-MOIA, Mount Bidela, Parede de Nhordés (wall of God) are some of the nature charms that you can also enjoy in São Domingos.

Come along and soak up the infectious magic of the most African island of the archipelago.



It is located south-east of the island of Santiago, comparing with the Atlantic Ocean to the east, Municipalities of Praia to the south, Santa Cruz north, Ribeira Grande de Santiago to the west and São Lourenço dos Orgãos to northwest. Was elevated to City by Law No. 77 / VII / 2010, published in the Official Gazette of August 23, 2010. São Domingos has a population of approximately 13,808 inhabitants according to the 2010 Census, divided into two parishes with 27 locations.

QUINTAS DO CAMPO SUBDIVISION - Phase1

ON SALE NOW

Plots (small farms) with an approximate area of 1000 sq m, on the island of Santiago in the municipality of São Domingos.

Located 15Km far from Praia International Airport, 7km far from the beach of São Francisco, 6km far from Vale da Costa (Sambala) and 2km far from Portal village and other fantastic beaches - the Baixo beach and Moia Moia beach.

Well located properties with good access to the area

QUINTAS DO CAMPO SUBDIVISION

Sopra Bolo – São Domingos



QUINTAS DO CAMPO SUBDIVISION - Phase 1



356 plots with 1.000 sq m aproximately

QUINTAS DO CAMPO SUBDIVISION – Phase 2



- Legenda**
- 6.00 - Área de Pav. (Paved Area)
 - 6.01 - Área de Pav. (Paved Area)
 - 6.02 - Área de Pav. (Paved Area)
 - 6.03 - Área de Pav. (Paved Area)
 - 6.04 - Área de Pav. (Paved Area)
 - 6.05 - Área de Pav. (Paved Area)
 - 6.06 - Área de Pav. (Paved Area)
 - 6.07 - Área de Pav. (Paved Area)
 - 6.08 - Área de Pav. (Paved Area)
 - 6.09 - Área de Pav. (Paved Area)
 - 6.10 - Área de Pav. (Paved Area)

MUNICÍPIO DE
ARAPUÁZ DE S. P.

SECRETARIA DE URBANISMO E OBRAS

10/08/2010

10/08/2010

10/08/2010

- NOTAS**
1. - Verificar o terreno.
 2. - Verificar o terreno.
 3. - Verificar o terreno.
 4. - Verificar o terreno.
 5. - Verificar o terreno.
 6. - Verificar o terreno.
 7. - Verificar o terreno.
 8. - Verificar o terreno.
 9. - Verificar o terreno.
 10. - Verificar o terreno.
 11. - Verificar o terreno.
 12. - Verificar o terreno.
 13. - Verificar o terreno.
 14. - Verificar o terreno.
 15. - Verificar o terreno.
 16. - Verificar o terreno.
 17. - Verificar o terreno.
 18. - Verificar o terreno.
 19. - Verificar o terreno.
 20. - Verificar o terreno.
 21. - Verificar o terreno.
 22. - Verificar o terreno.
 23. - Verificar o terreno.
 24. - Verificar o terreno.
 25. - Verificar o terreno.
 26. - Verificar o terreno.
 27. - Verificar o terreno.
 28. - Verificar o terreno.
 29. - Verificar o terreno.
 30. - Verificar o terreno.
 31. - Verificar o terreno.
 32. - Verificar o terreno.
 33. - Verificar o terreno.
 34. - Verificar o terreno.
 35. - Verificar o terreno.
 36. - Verificar o terreno.
 37. - Verificar o terreno.
 38. - Verificar o terreno.
 39. - Verificar o terreno.
 40. - Verificar o terreno.
 41. - Verificar o terreno.
 42. - Verificar o terreno.
 43. - Verificar o terreno.
 44. - Verificar o terreno.
 45. - Verificar o terreno.
 46. - Verificar o terreno.
 47. - Verificar o terreno.
 48. - Verificar o terreno.
 49. - Verificar o terreno.
 50. - Verificar o terreno.
 51. - Verificar o terreno.
 52. - Verificar o terreno.
 53. - Verificar o terreno.
 54. - Verificar o terreno.
 55. - Verificar o terreno.
 56. - Verificar o terreno.
 57. - Verificar o terreno.
 58. - Verificar o terreno.
 59. - Verificar o terreno.
 60. - Verificar o terreno.
 61. - Verificar o terreno.
 62. - Verificar o terreno.
 63. - Verificar o terreno.
 64. - Verificar o terreno.
 65. - Verificar o terreno.
 66. - Verificar o terreno.
 67. - Verificar o terreno.
 68. - Verificar o terreno.
 69. - Verificar o terreno.
 70. - Verificar o terreno.
 71. - Verificar o terreno.
 72. - Verificar o terreno.
 73. - Verificar o terreno.
 74. - Verificar o terreno.
 75. - Verificar o terreno.
 76. - Verificar o terreno.
 77. - Verificar o terreno.
 78. - Verificar o terreno.
 79. - Verificar o terreno.
 80. - Verificar o terreno.
 81. - Verificar o terreno.
 82. - Verificar o terreno.
 83. - Verificar o terreno.
 84. - Verificar o terreno.
 85. - Verificar o terreno.
 86. - Verificar o terreno.
 87. - Verificar o terreno.
 88. - Verificar o terreno.
 89. - Verificar o terreno.
 90. - Verificar o terreno.
 91. - Verificar o terreno.
 92. - Verificar o terreno.
 93. - Verificar o terreno.
 94. - Verificar o terreno.
 95. - Verificar o terreno.
 96. - Verificar o terreno.
 97. - Verificar o terreno.
 98. - Verificar o terreno.
 99. - Verificar o terreno.
 100. - Verificar o terreno.

PROJETO
Autuário - Praça
Sustentável Unipassado, Lda

PROJETO ARQUITETÓNICO
Quintas do Campo

DATA 10/08/2010 **SCALE** 1:500

PLANTA DE REGULAÇÃO **A-06**

PROJETADE **DATA** **ESCALA**

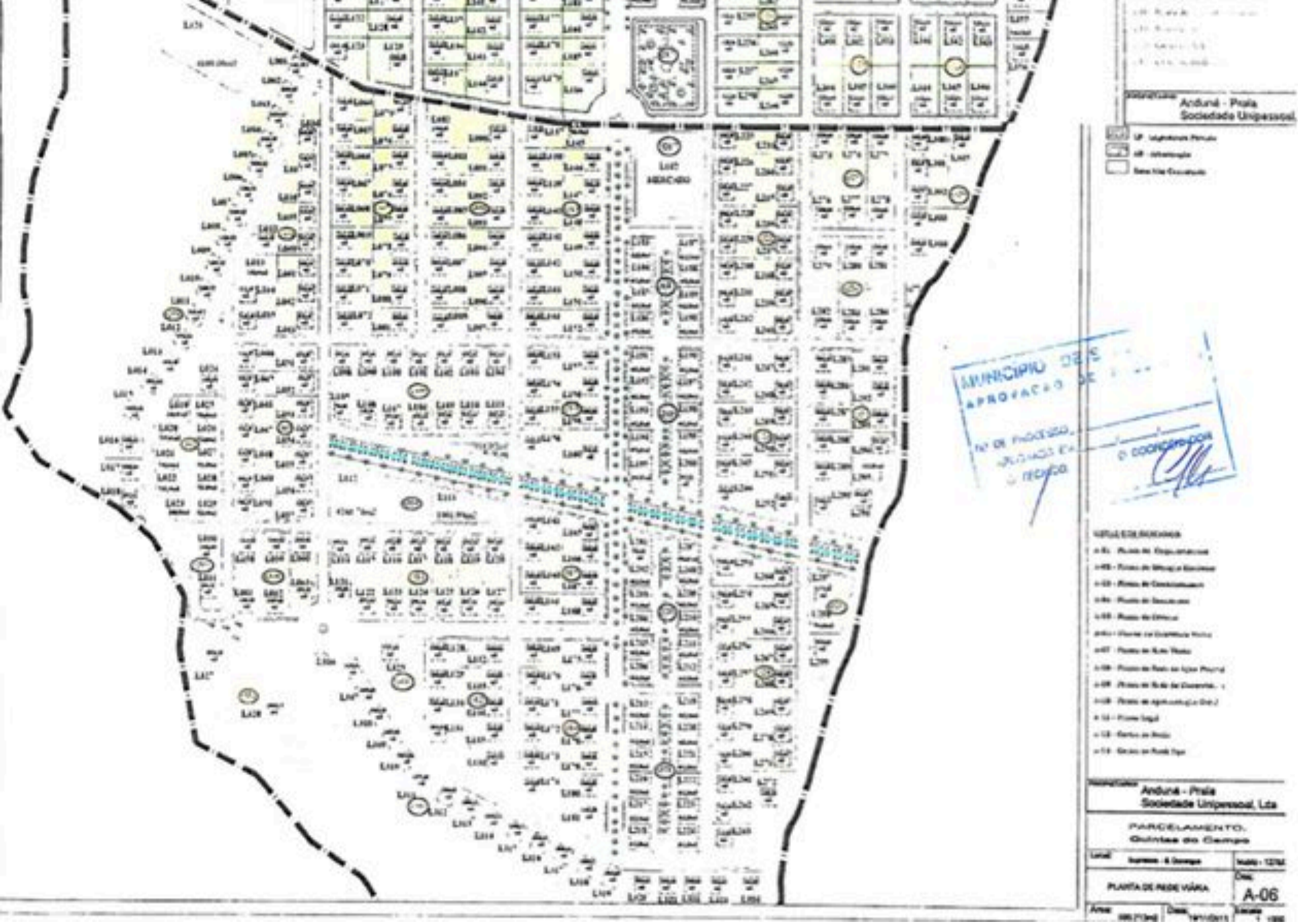

328 plots with 1.000 sq m approximately

S. Francisco Beach



S. Francisco Beach



S. Francisco Beach



S. Francisco Beach



Moia Moia Beach



Baixo Beach





QUINTAS DO CAMPO
SOPRA BOLO

1,8 Km ←

QUINTAS DO CAMPO SUBDIVISION - Phase1

1. The sale of plots is held by public deed in the **Praia Notary Office**, to make the detach (highlight) of the property, with confrontations, areas and numbers of each parcel, free from any mortgage or occupations.

The land is part of the subdivision (Quintas do Campo) with approximately 650 plots of 1000 sqm, divided into two (2) phases.

The plots of land are clearly marked with milestones in cement and numbered, with wide streets, sidewalks, parking lots, green areas and other, all on unpaved (maquedame). The rest of the infrastructure when needed should be determined and borne by all owners.

2. The supply of water and electricity in the area is 2km far at Portal village. While there are some buildings and wish to supply electricity, is cheaper if the station is divided by all. To water can be allowed a collective hole or any other alternative owners decide.

3. If you want to acquire one of the plots and can not travel to Cape Verde, we have a legal, safe and honest way to permit execute the deed and the registration form on behalf of the buyer. All documentation is in order to be able to notarize the land.

4. Plots (Quintas do Campo) have a favorable opinion of the Municipality of São Domingos, where can be built up to 20% of the plot, respecting the Urban Development Plan zone, which is Agro-Silvo-Pastoril.

What is Agro-Silvo-Pastoril?

It is an area that is planned and approved by the Municipality of São Domingos, for grazing, farming, ranching, residential, retail and leisure, being mandatory that parcel owners, when they want to build, have to submit the construction project to the House of São Domingos, for analysis and assessment, as the Urban Development Plan zone

5. From this point we start selling of phase 1.

That given the morphology, location and accessibility conditions (with better or worse access) of each plot will have different prices and the following conditions. (Amounts are in Euros and Cape Verdean Escudos):

******* VALID PRICES ONLY UNTIL January, 31st, 2015 *******

Orange Plots – 2.709,00€ - 298.000\$00

Yellow Plots – 3.354,00€ - 369.000\$00

Green Plots – 3.990,00€ - 438.900\$00

******* VALID PRICES ONLY UNTIL January, 31st, 2015 *******

Other expenditures related with purchase (approximated values):

Scripture - € 270.00 - 29.700\$00

Conservatory Land Registry - € 320.00 - 35.200\$00

IUP (Sisa) - 1.5% of purchase price

ATTENTION

By decision of the Quintas do Campo's Promoter and given the Christmas and New Year Season's approaching, it was decided to extend the launch prices of the project until **January 31, 2015**, entering, on that date, the **new prices, if there are remaining plots in 1st phase, for sale.**

ATTENTION

A new **PRICE LIST** becomes effective from

January, 31st, 2015

Orange Plots – 3.709,00€ - 408.000\$00

Yellow Plots – 4.354,00€ - 479.000\$00

Green Plots – 4.990,00€ - 548.900\$00

Take a time to plan carefully your investment

6. There are no existence on Santiago Island of plots of land with 1000 sqm for sale at prices as low as those of the Quintas do Campo, despite having only basic infrastructures. It was impossible to keep these prices with the global infrastructure of an complete urbanization.

Investing in land at low price, its profitability, and your profit will be higher than in banking investments, or term deposits, bank products or stock exchange activities. Please analyze very well all risks.

The world population is growing every day, but the land does not grow.

The values listed for sale may be changed without notice, but we satisfy all reserves within the given deadline.

NOW ENJOY THE IMAGES

BENVINDO
Quintinhas Do
Campo











213



































BOA VIAGEM



BOM INVESTIMENTO PARA:

Retirees who want to have a pleasant place to spend part of the year;

Immigrants who want to make a protected investment - land;

Immigrants who want to buy land and build a family home;

Foreign citizens retired or not;

Cape Verdean citizens seeking place to put down roots.

Etc.

CONTACTS for INFORMATIONS and SALES

General Sales – vendas@quintasdocampo.com;

Sales Group

Rui Lemos - +351 962 437 048

rl@quintasdocampo.com

A. D. Neto - +351 963 057 973

an@quintasdocampo.com

VISIT US

<http://www.quintasdocampo.com>